

THIS DETAIL ALONG WITH ITS CONCEPTS, SHAPE AND SIZES ARE THE PROPRIETARY PROPERTY OF ENTRANCE METAL, A DIVISION OF DORALCO, INC. IT MAY NOT BE TRANSFERRED IN ANY FORMAT TO ANY OTHER PERSON OR ENTITY, IN CONCEPTS OR DESIGN. THIS DETAIL IS NOT INTENDED FOR THE PURPOSE OF FABRICATION.

**DORALCO**

5919 W 118th STREET  
 ALSIP, IL 60803  
 Phone: (708) 388-9324  
 Fax: (708) 388-9392

REFERENCE

**E-Z GLAZE SOUND STRIP DETAILS**

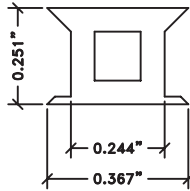

**E-Z GLAZE SOUND STRIP**  
**1/4" GAP FOR 1/4" THICK GLASS**

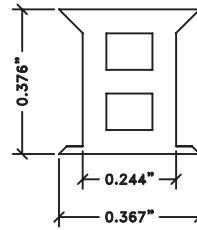

**E-Z GLAZE SOUND STRIP**  
**1/4" GAP FOR 3/8" THICK GLASS**

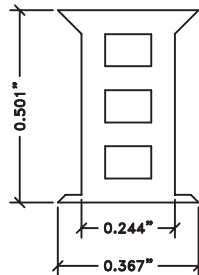

**E-Z GLAZE SOUND STRIP**  
**1/4" GAP FOR 1/2" THICK GLASS**